

17 Brookleaze Buildings, Bath, BA1 6RA
 Approx. Gross Internal Area
 Main House 859 sq ft - 80 sq m
 Garage 188 sq ft - 17 sq m
 Total Area 1,047 sq ft - 97 sq m

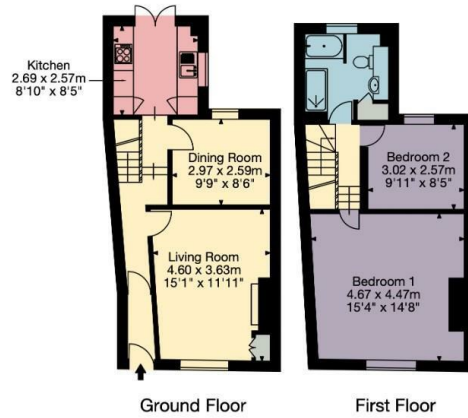
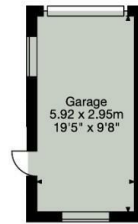

KEY
 Kitchen
 Living Area
 Bedroom
 Bathroom
 Storage

Zest, 1a Mile End, London Road, Bath, BA1 6PT
 happytohelp@zestlovesproperty.com
 01225 481010

VIEWING AND OFFER PROCEDURE: If you wish to view this property, please contact our office on the number provided. All offers on this property should be made through this office. In order to fulfill our responsibilities to the seller, when offering on this property, you will be asked a series of questions about how you intend to fund the purchase and whether or not your offer is dependent on the sale of another property. This information provided by you, along with the amount of your offer, will then be forwarded onto the seller for consideration.

MONEY LAUNDERING REGULATIONS - Intending purchasers will be asked to produce identification documentation at a later stage and we would ask for your cooperation with this in order that there will be no delay in agreeing the sale.

DISCLAIMER: All appliances, apparatus, equipment, fixtures and fittings listed in these details are only 'as seen' and have not been tested by Zest, nor have we sought certification of warranty or service, unless otherwise stated. It is in the buyers interests to check the working condition of any appliances. Any floor plans and or measurements provided are given as a general guide to room layout and design only. They are supplied for guidance only - they are not exact and must not be relied upon for any purpose, and therefore must be considered incorrect. As a potential buyer you are advised to recheck the measurements before committing to any expense. These details are offered on the understanding that all negotiations are to be made through this company. Neither these particulars, nor verbal representations, form part of any offer or contract, and their accuracy cannot be guaranteed. Zest has not sought to verify the legal title of the property and the buyer(s) must obtain verification from their solicitor.

ZEST ESTATE AGENTS

1A MILE END
 LONDON ROAD
 BATH
 BA1 6PT

T: 01225 48 10 10
 E: HAPPYTOHELP@ZESTLOVESPROPERTY.COM



01225 48 10 10 • happytohelp@zestlovesproperty.com • www.zestlovesproperty.com

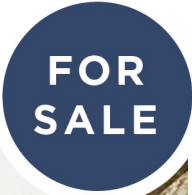

**BROOKLEAZE BUILDINGS,
 LARKHALL BA1 6RA**
 2 BEDROOM HOUSE

**GUIDE PRICE
 £470,000**

- Grade II Listed Georgian Town House
- Recently renovated throughout to an exceptionally high standard
- Located in the heart of Larkhall
- Two bedrooms, luxury bathroom
- Living room, dining room kitchen opening into rear garden
- Pretty level landscaped gardens and a garage



DESCRIPTION

A beautifully renovated Georgian townhouse, nestled in the heart of Larkhall. This elegant property benefits from a separate lounge and dining area, as well as a new kitchen with modern integrated appliances, two bedrooms and a luxury bathroom with a bath and a separate large shower. This exquisite period property combines period charm and contemporary style living at its best. There are landscaped gardens to the front and rear with the rear garden benefitting from a south/west aspect. At the end of the rear garden there is a good sized garage and pedestrian access onto Salisbury Road.

LOCATION

Brookleaze Buildings is just a few steps away from Larkhall Village. Larkhall is a

popular village known for its vibrant community, array of independent shops and excellent local schools. The property enjoys good bus links to the centre of Bath and easy access to the M4 without having to cross the city.

The city centre of Bath provides a full range of retail outlets together with many amenities including an excellent selection of restaurants, Bath Sports Centre, the Theatre Royal and the Thermae Spa. Complementing this is the open countryside to the east with many beautiful walks. This contrasting with the closeness of the city centre is, in our opinion, one of the major attractions to this property. Communication links are excellent with a mainline rail link to London Paddington (journey time from 85 minutes) and Bristol Temple Meads (journey time from 15 minutes).

